



Installation guide  
Thermory® cladding



- 1. Types of Cladding.....
- 1.1. Horizontal cladding.....
- 1.2. Vertical cladding.....
- 2. Installing.....
- 2.1. Installing with screws.....
- 2.2. Installing with Thermory® clips.....
- 3. Battens.....
- 3.1. Horizontal cladding.....
- 3.2. Vertical cladding.....
- 4. Bottom fixing.....
- 5. Corner design.....
- 6. Surface treatment.....
- 7. Additional information.....

## 1. TYPES OF CLADDING

### 1.1 Horizontal cladding:

- Thermory® profiles C1, C2, C3, C6, C7, C8, C9 and C11 are meant for horizontal cladding.
- Tongue and groove boards (C1, C3, C8 etc) have to be installed with the tongue pointing upwards.

SOME BASIC HORIZONTAL INSTALLATION POSSIBILITIES:

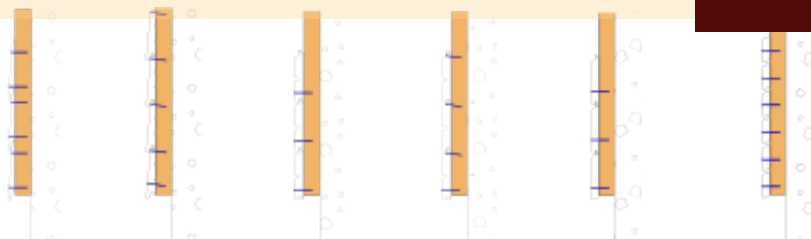

**1.2 Vertical cladding:**

- Thermory® profiles C1 and C3 are applicable also for vertical installation, profile C5 is applicable only for vertical installation.

SOME BASIC VERTICAL INSTALLATION POSSIBILITIES:

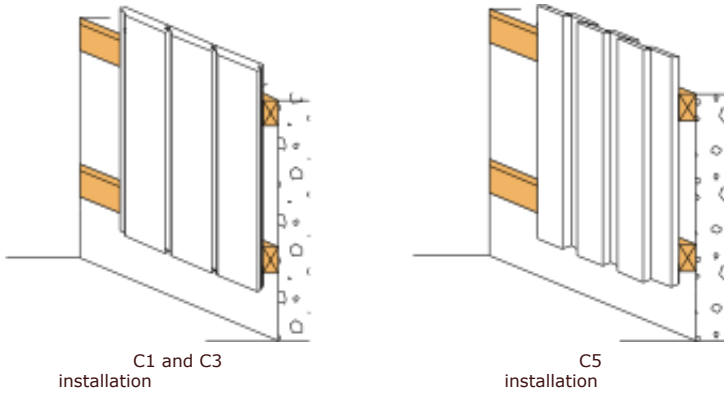

---

## 2. INSTALLING

Always use stainless steel screws or Thermory® fastening clips for installing Thermory® cladding.

**2.1 Installing with screws:**

- The pilot hole should be a slightly larger in diameter than the screw itself, to allow necessary movement and prevent splits. This holds in particular for thermo-treated ash. Thermo-treated pine can be screwed with self-drilling screws.

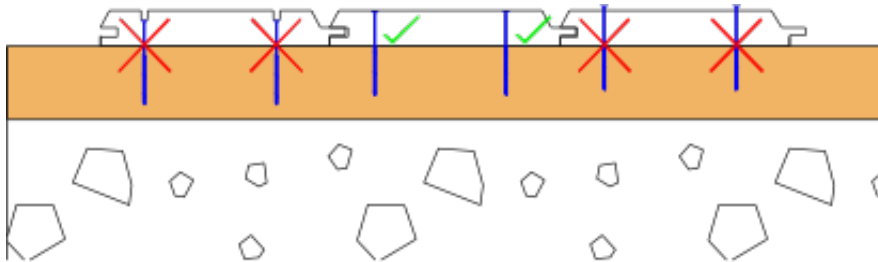

Screw head must not penetrate too deep into the wood. Screw head should seat snugly and be approximately level with the wood surface in order to reduce risk of water absorption.

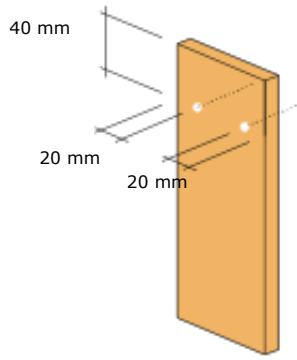

In order to avoid splitting of timber, leave ca. 20 mm space from the edge and 40 mm from the end of the board for drilling.

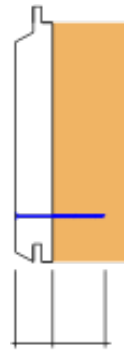

Min 2x thickness of the board

Length of screw/nail: minimum 2x thickness of the board at its thickest point.

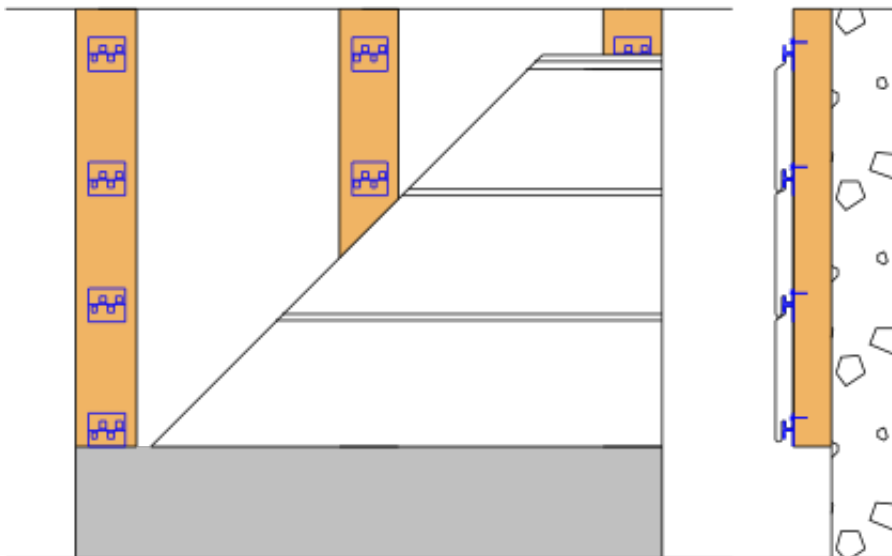
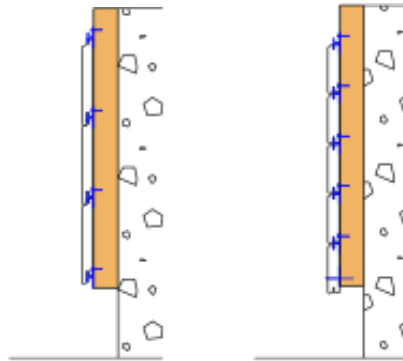

---

### 2.1 Installing with Thermory® clips:

Use Thermory® fastening clips for hidden installation. B1 clip is suitable for profiles C6 and C9. Estimated usage of clips 1,7 pcs per running meter (considering battens in every 600 mm). Use stainless steel screws to attach the clips to the batten, 2 screws for each clip is enough.

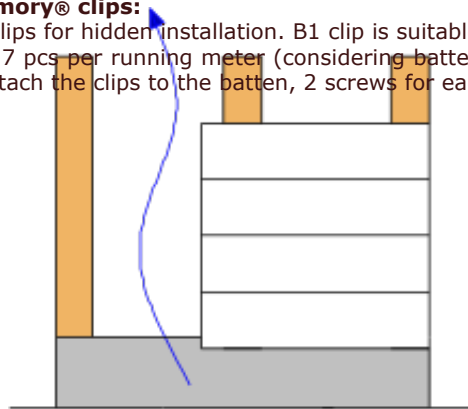

05

Installing C6 with B1 Thermory® clips

Installing C9 with B1 Thermory® clips

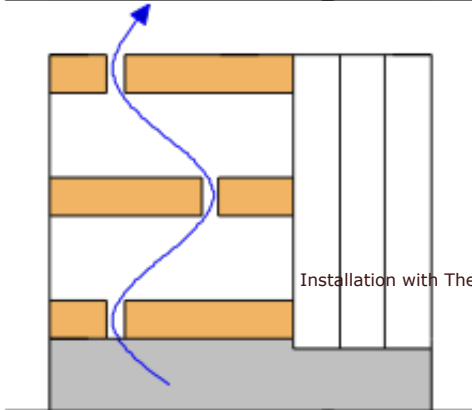
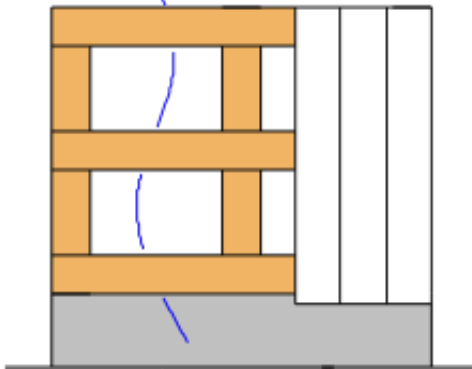

Installation with Thermory® clips

---

## 3. BATTENS

We recommend to use thermo-treated spruce with resistance class 1. Battens must be placed maximum every 600 mm. Ventilation should be provided behind the boards.

### 3.1 Horizontal cladding

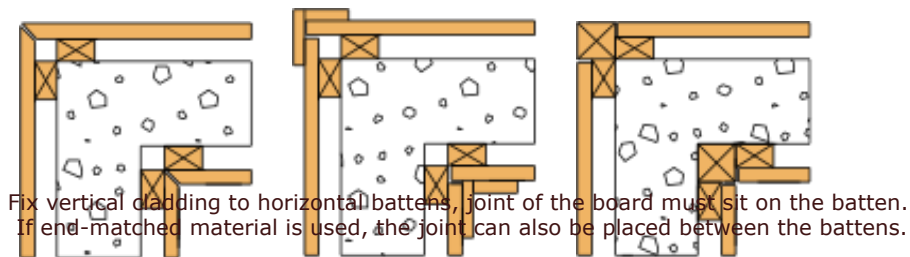
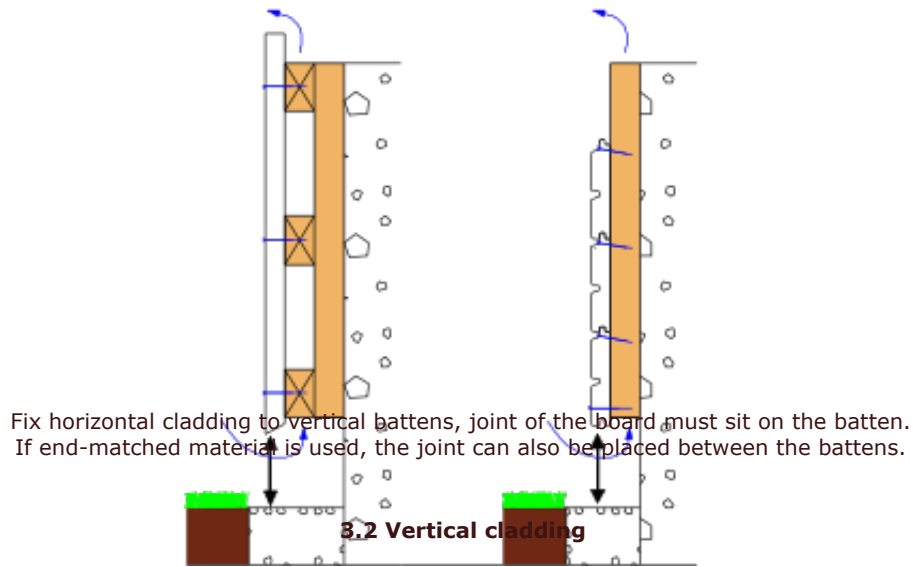

---

---

## 4. BOTTOM FIXING

It is recommended to leave minimum 300 mm gap between the ground and cladding. Ventilation gap behind the cladding must stay open from below to ensure air circulation.

